

Plug and Play Alarm System with Combination Audio-Visual and BMS Capability

EAA953PP

In an emergency situation, every second counts... a quick response is paramount when it comes to minimising the impact of a workplace injury.

Those precious first few seconds really do count, and installing an alarm system is a great way of making sure workmates and first aid personnel are immediately aware that an employee is injured and requires urgent assistance.

The EAA953PP plug and play system means quick and easy installation to get your site ready, just in case an accident does occur.



KEY FEATURES

- 24V system
- Audio-visual and BMS capability
- Suitable for installation in non-hazardous zones
- Alarm system can be retrofitted to existing shower and eye wash system
- Electronic inline flow sensor triggers the alarm, transmits signal to activate the red beacon, sounder and signal to the BMS
- Electronic inline pressure sensor triggers alarm, transmits signal to activate amber beacon, sounder and a signal to the BMS

PRODUCT CODES

EAA953PP	Suitable for combination shower and eye/ eye face wash
EAA953PP-E	Suitable for eye/ eye face wash
EAA953PP-P	Suitable for platform shower

Version 2.0__15Sep22

Plug and Play Alarm System with Combination Audio-Visual and BMS Capability

TECHNICAL INFORMATION

Input / Output Voltage	240V / 24V
IP Rating (Alarm System)	IP65
Flow Sensor	Electronic; able to pre-set flow rate required (by customer)
Pressure Sensor	Electronic; able to pre-set pressure drop point (by customer)
Sounder – Decibel Rating	103 dB(A) typical @ 1m
Beacon Lens Colours	Red (Flow Sensor) and Amber (Pressure Sensor)

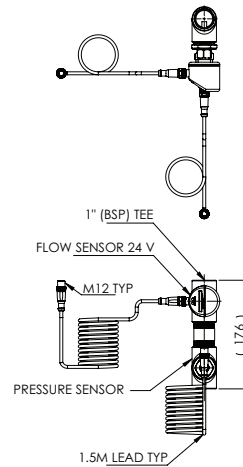
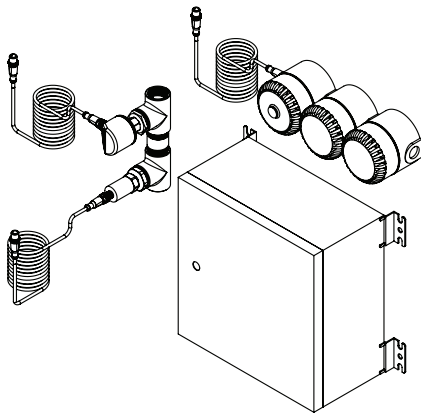
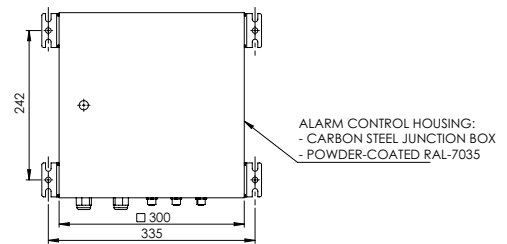
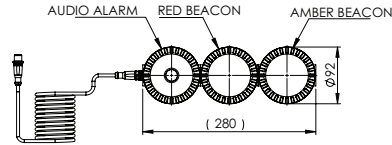
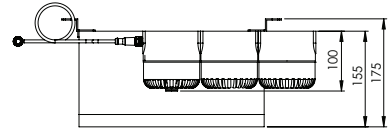

Enware Australia advises:

1. Due to ongoing Research and Development, specifications may change without notice. 2. Component specifications may change on some export models. 3. Refer to warranty statement for warranty details - www.enware.com.au/warranty

Version 2.0__15Sep22

Plug and Play Alarm System with Combination Audio-Visual and BMS Capability

INSTALLATION INFORMATION

PLUG & PLAY INSTALLATION

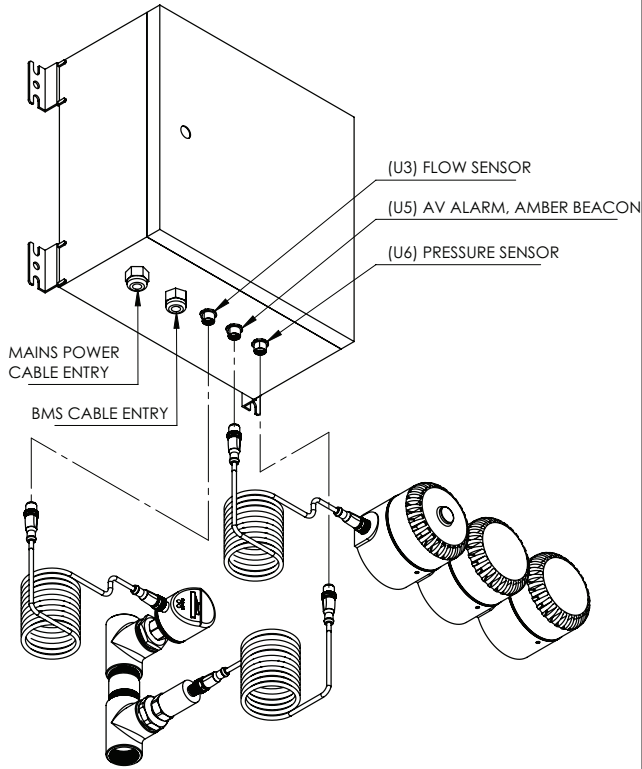

INTERNAL ELECTRICAL CONNECTION

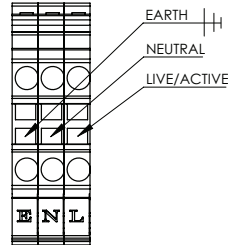

- MAIN POWER INPUT**
- NOMINAL VOLTAGE: 230VAC.
 - NOMINAL FREQUENCY: 50Hz
 - NOMINAL CURRENT: 1A
 - CABLE DIAMETER: 5 - 10mm
 - WIRE SIZE: 0.14 - 1.5mm²

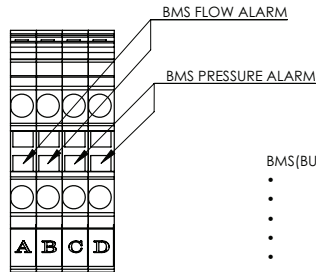

- BMS (BUILDING MANAGEMENT SIGNAL):**
- INTERFACE TYPE: SWITCH (DRY CONTACT)
 - OUTPUT TYPE: OPEN/CLOSE (ALARM=RELAY CLOSED)
 - MAX. VOLTAGE: 125VDC, 380VAC.
 - MAX. CURRENT: 3A
 - CABLE DIAMETER: 5-10mm
 - WIRE SIZE: 0.14-1.5mm²

NOTES:-

1. ALL HARD WIRED CONNECTIONS TO BE MADE BY A LICENCED ELECTRICIAN.
2. CONNECTION TO APPROPRIATE TERMINALS TO BE COMPLETED AS PER AS/NZS 3000:2018.

24V NON HAZARDOUS AUDIO VISUAL BMS, FLOW AND PRESSURE SENSOR

EAA953PP | EAA953PP-E | EAA953PP-P

SIGNAL

SENSORS

When the shower and/or eyewash is activated by sensing the flow of water or a pressure drop, a signal will be automatically sent to the junction box.

PRESSURE SENSOR

FLOW SENSOR

JUNCTION BOX

A trigger from the sensors will send a signal to the sounder and beacons and BMS.

SOUNDER & BEACONS

SOUNDER

Sounder activated by flow or pressure sensors

RED BEACON

Red Beacon activated by flow sensor

AMBER BEACON

Amber Beacon activated by pressure sensor

BMS

Signal sent to BMS by flow or pressure sensors

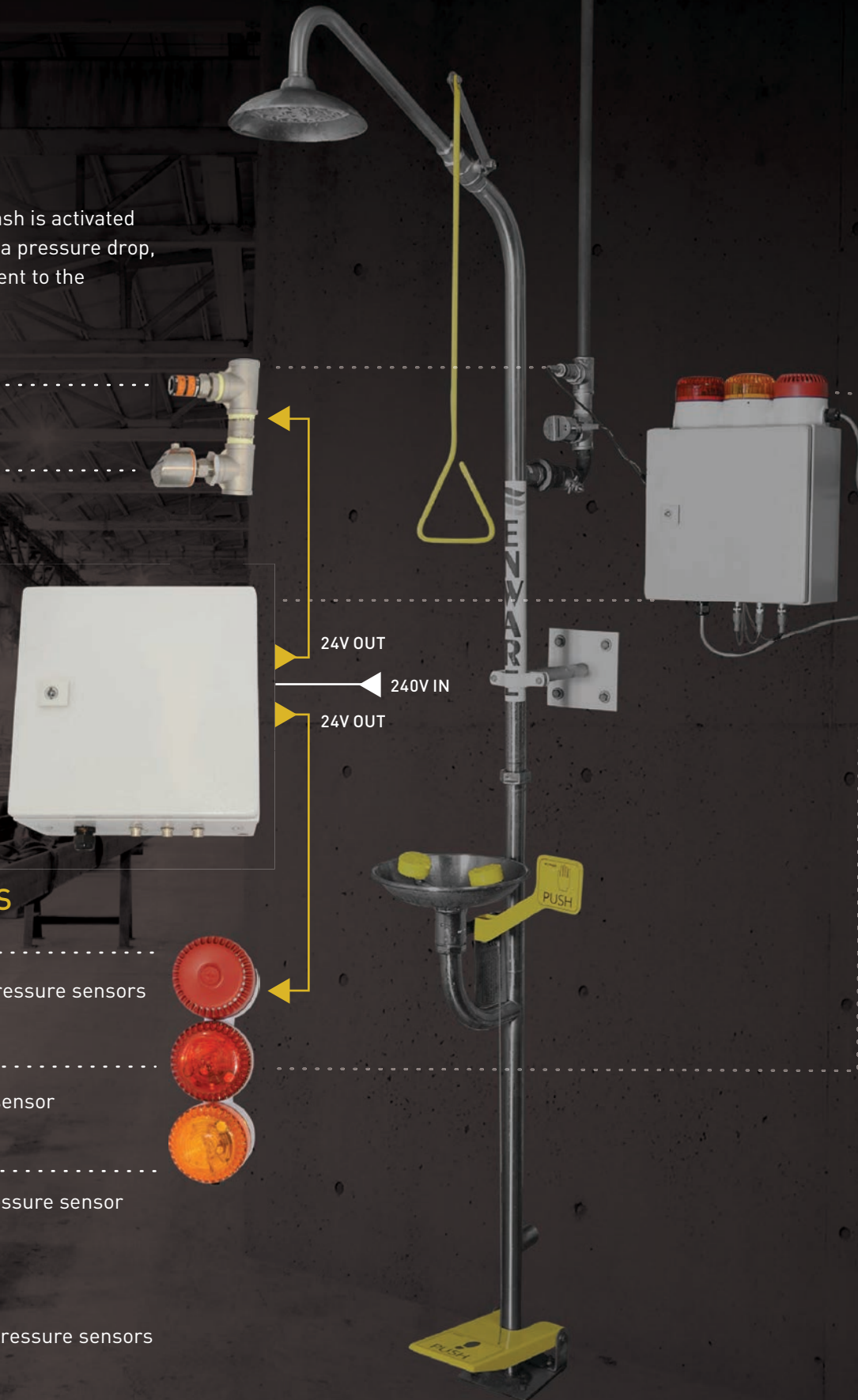

Call 1300 369 273

www.enware.com.au

Enware Australia Pty Limited

9 Endeavour Rd Caringbah NSW 2229 Australia



Version: June 19