

Bench Mounted Swivel Eye Wash Hand Operated

EL570

Bench mounted swivel eyewash with hand activated stay open valving. When required, the emergency eye wash swivels over the sink, set at appropriate height and is conveniently out of the way during normal sink use.

KEY FEATURES

- Aerated outlets
- Ceramic disc stay open valve
- Chrome plated DZR brass body
- Powder coated finishes available

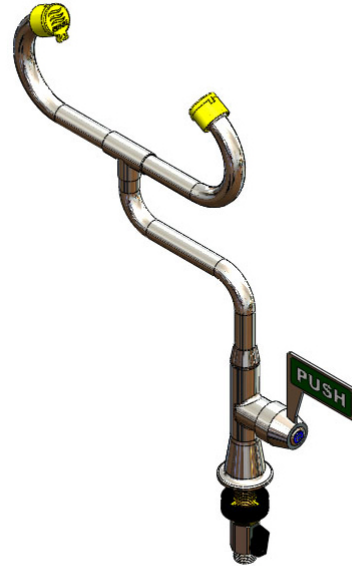

PRODUCT CODES

EL570	Standard Chrome Plated
EL570GR	Green Epoxy Powdercoated Finish
EL570OR	Orange Epoxy Powdercoated Finish
EL570YE	Yellow Epoxy Powdercoated Finish
EL570WH	White Epoxy Powdercoated Finish

Version 2.0__22Jul22

Bench Mounted Swivel Eye Wash Hand Operated

TECHNICAL INFORMATION

Inlet Connection	15mm (1/2" BSP) male
Water Supply Line Size	Must be hydraulically sized to meet requirements.
Minimum Pressure	210 kPa (to achieve ANSI Z358.1 and AS4775 compliance) 80 kPa (not requiring ANSI Z358.1 and AS4775 compliance)
Minimum Flow Rate	12 L/min
Eyewash Outlet Size	15mm (1/2" BSP) aerated outlets
Shipping Weight	3kg

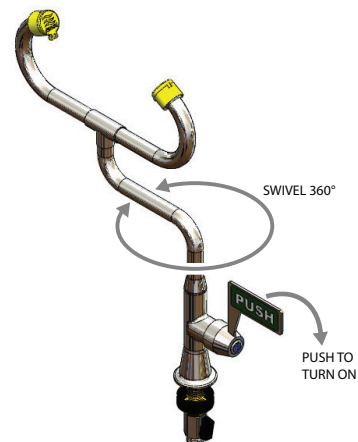
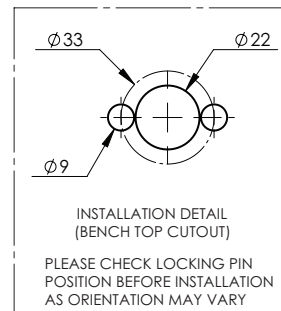
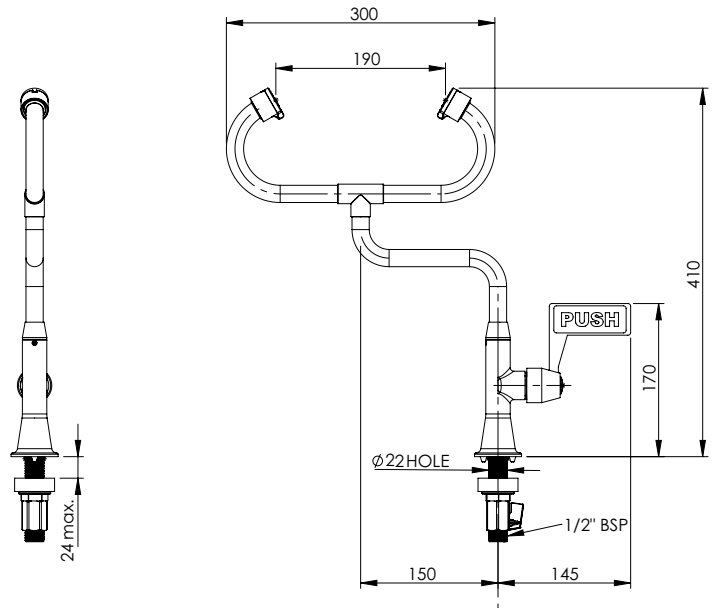

Installation of emergency eye wash equipment shall be in accordance with AS/ NZS4775 or ANSI Standard Z358.1 - whichever is applicable to the installation.

Enware Australia advises:

1. Due to ongoing Research and Development, specifications may change without notice.
2. Component specifications may change on some export models.
3. Refer to warranty statement for warranty details - www.enware.com.au/warranty

Version 2.0__22Jul22